

DO NOT SCALE

- Proposed roundabout solution on A40.
1. Assume minimum ICD of 50m. This is based upon existing roundabout dims on A40.
  2. Design speed to be 100kph (60mph)
  3. Design based upon DMRB CD116
  4. Assume no MNU provision on proposed roundabout.
  5. Existing carriageway profile 7.3m carriageway with 1m hardstrips, 3.5m verges.
  6. Assume batters slope to be 1:3

KEY

EXISTING CARRIAGEWAY	
VERGE	
VISIBILITY SPLAY	
SITE BOUNDARY	
THIRD PARTY LAND HOLDING	(CX)

INBOUND SLIP ROAD MIN 6M CARRIAGEWAY WIDTH AND MIN 1M HARD STRIP (SUBJECT TO VISIBILITY AND SWEEPED PATH CHECKS)

85M LONG AUXILIARY LANE 4.0M WIDE

EXISTING JUNCTION SIGNALISED POTENTIALLY PART TIME TO ALLOW EXIT FROM HOSPITAL UNOPPOSED AND PREVENT BLOCKING BACK ONTO A40

PROPOSED SIMPLE T JUNCTION TO TIE INTO OLD A40 AND TO SITE ACCESS

PROPOSED TURNING HEAD

THIS PROVISIONAL PRELIMINARY DESIGN IS FOR GUIDANCE PURPOSES ONLY. WSP ACCEPTS NO LIABILITY FOR ANY DAMAGE, LOSS, EXPENSES OR COST INCURRED AS A RESULT OF RELYING ON THE INFORMATION PROVIDED IN THE DESIGN APPRAISAL ESTIMATE. THE APPRAISAL ESTIMATE WAS DERIVED FROM A MIXTURE OF THIRD PARTY INFORMATION AND THE APPLICATION OF WSP'S REASONABLE SKILL AND CARE, BUT MAY BE SUBJECT TO OTHER SUCH INFORMATION AND VARIATIONS OF WHICH WSP IS UNAWARE. THE DESIGN APPRAISAL ESTIMATE SHOULD NOT BE RELIED UPON FOR TENDER OR PROCUREMENT PURPOSES. FOR ACCURATE ADVICE A DETAILED DESIGN SHOULD BE CARRIED OUT AT THE APPROPRIATE DESIGN STAGE. THEREFORE, USE OF THE INFORMATION IS ENTIRELY AT YOUR OWN RISK.

File name: I:\UK\WSP\GROUP\COMCENTRAL\DATA\PROJECTS\70000000\7006204-HYWEL DDA CRITICAL CARE CENTRE SITE APPRAISALS\303\WPHW\HIGHWAYS\CG-CAD\BIM\MODELS\SS-19-05-2022\24-04-2022\WSP-XX-C-DR-HW-0001\_P02.DWG, printed on 10 May 2022 14:13:48, by Simpson, Ben

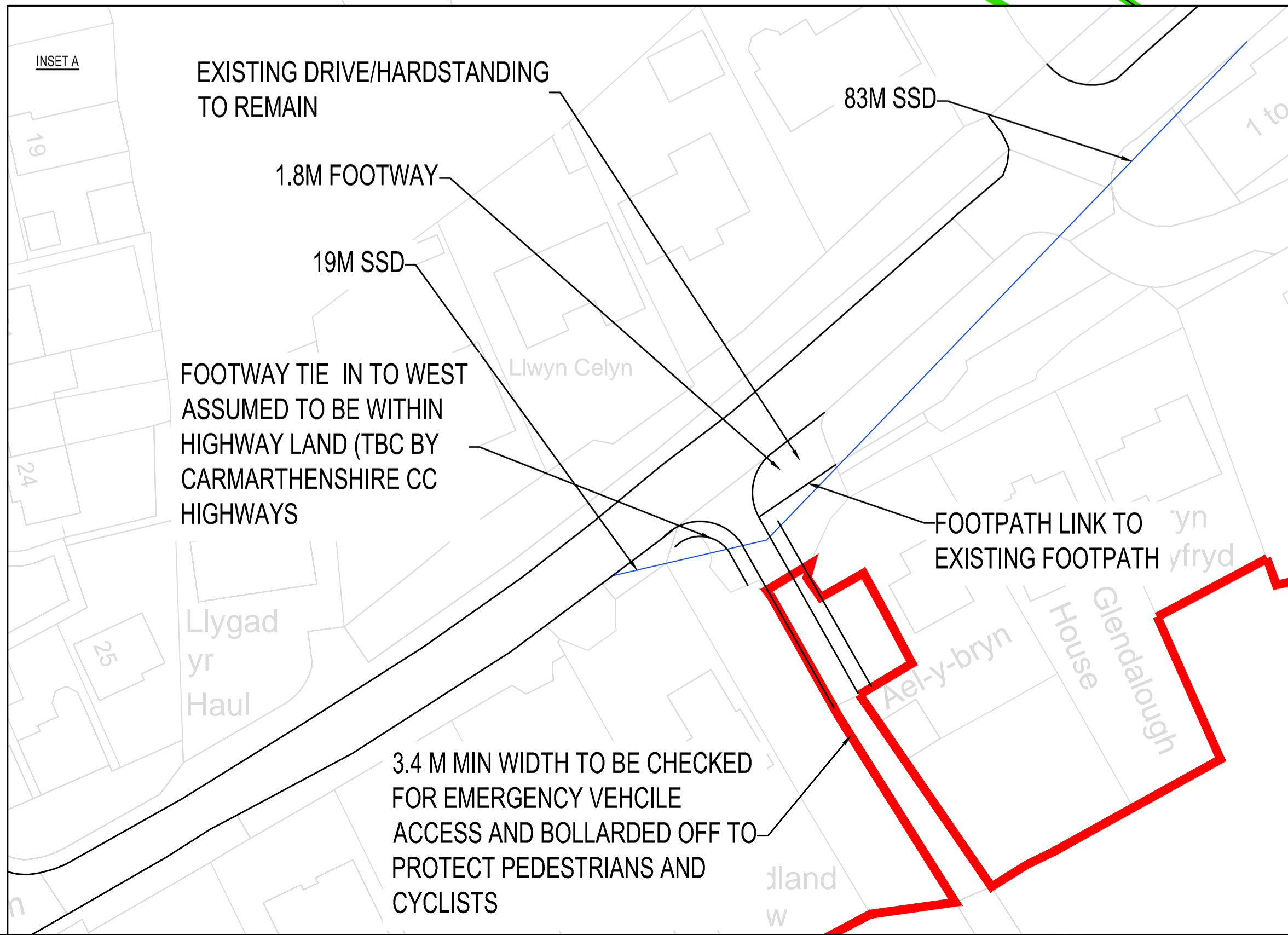
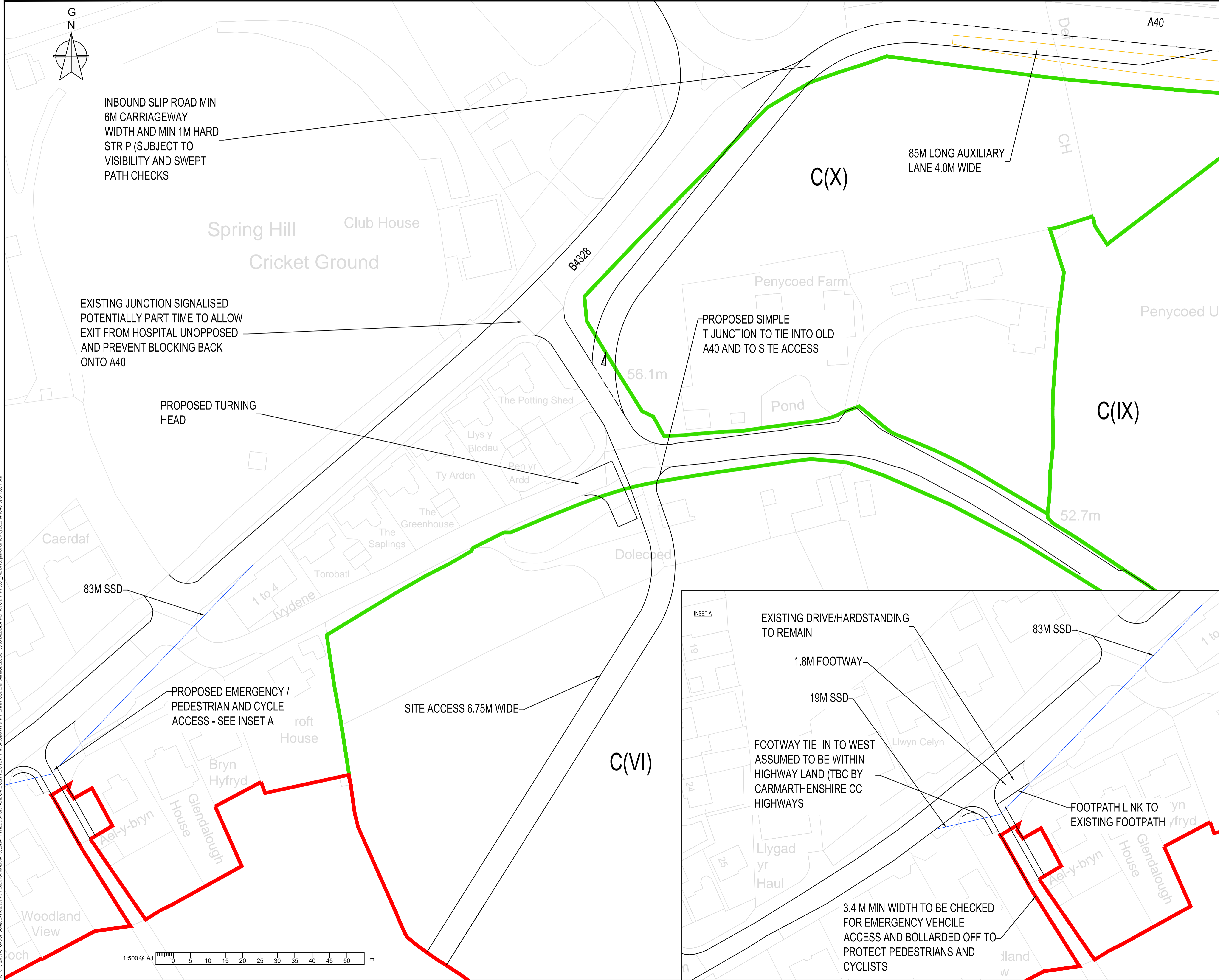

PO2	09/05/2022	BS	EAST TURNING HEAD REPLACED WITH A40 TIE IN	SWG	AW
P01	05/04/2022	BS	FIRST ISSUE	SWG <td>AW</td>	AW
REV	DATE	BY	DESCRIPTION	CHK	APP

DRAWING STATUS: **S0 - WORK IN PROGRESS**

1 Capital Quarter, Tyndall St, Cardiff, CF10 4BZ, UK  
T+ 44 (0) 292 076 9200  
wsp.com

CLIENT: BWRDD IECHYD PRIFYSGOL HWYEL DDA/ HWYEL DDA UNIVERSITY HEALTH BOARD

ARCHITECT: BDP

SITE/PROJECT: HYWEL DDA CRITICAL CARE CENTRE SITE APPRAISALS

TITLE: SITE C - LAND AT SPRING GARDENS RD WHITLAND - OPTION 1 - A40 ROUNDABOUT/LINK ROAD SCHEME

SCALE @ A1: 1:500	CHECKED: MT	APPROVED: AW
PROJECT NO: HYWEL DDA	DESIGNED: MCT	DRAWN: BS
		DATE: May 22

DRAWING NO: 2424-WSP-XX-C-DR-HW-0001	REV: P02
--------------------------------------	----------

© WSP UK Ltd

